

BOARDWALK BRACKETS FOR 1 1/2" O.D. PILE

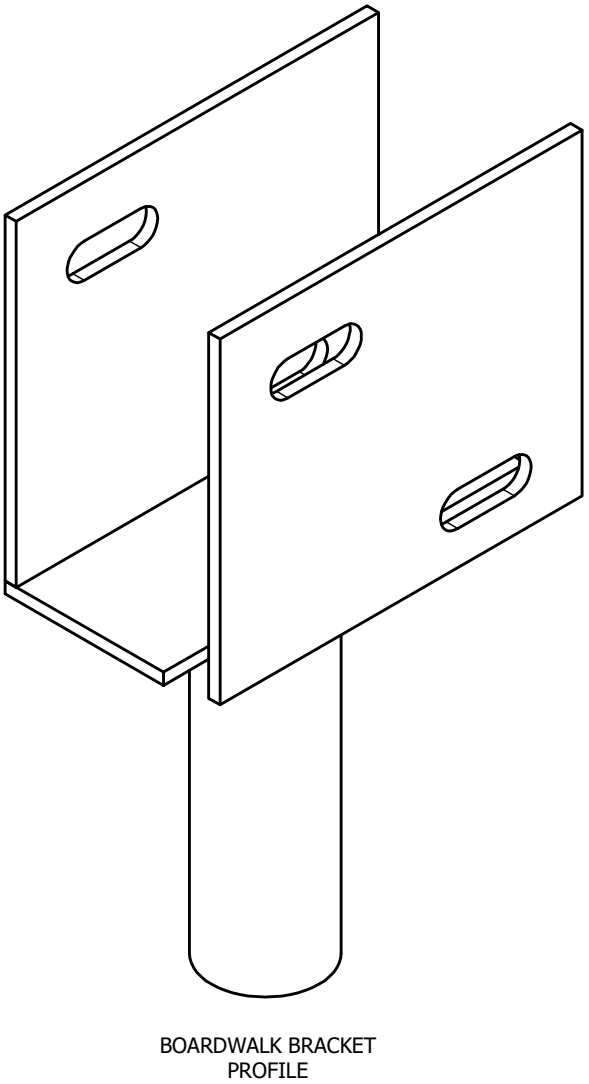
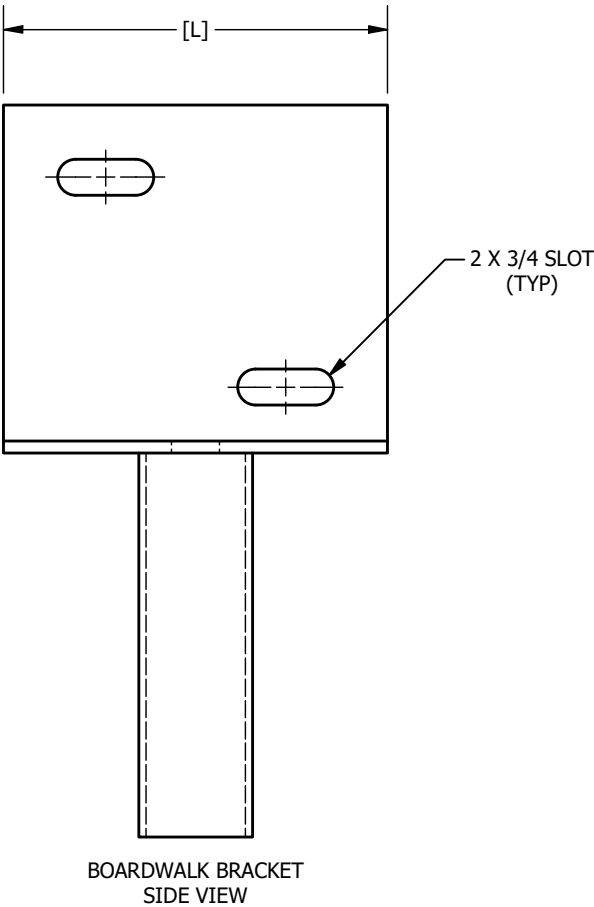
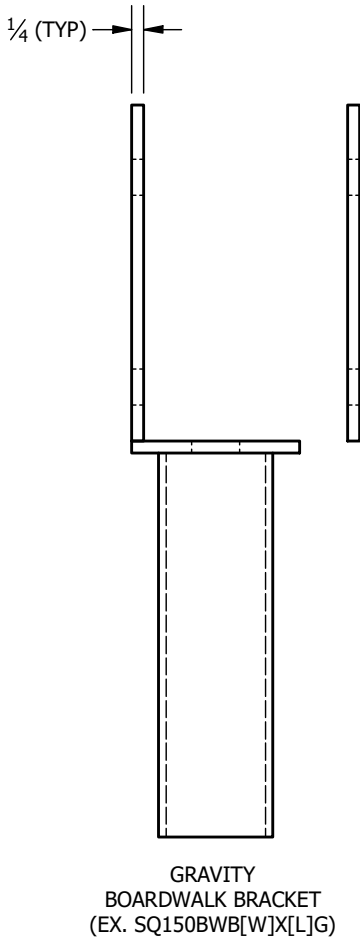
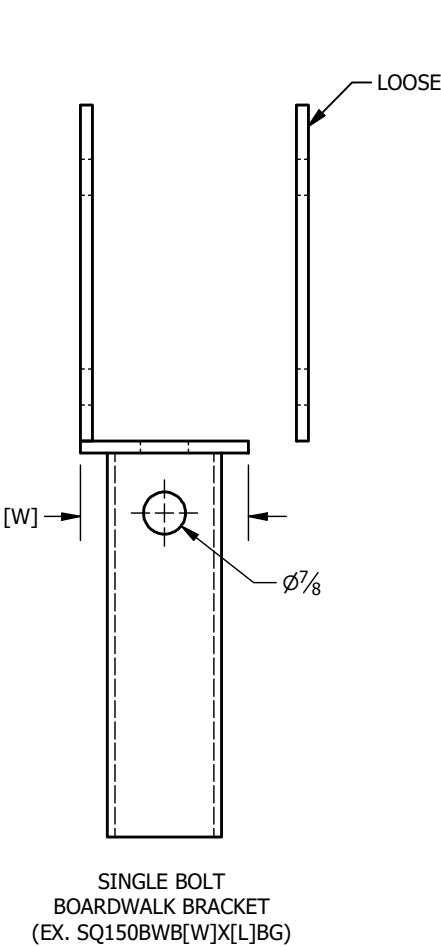

NOTES:

1. SLEEVE TO MEET OR EXCEED 55 KSI.
2. PLATE STEEL TO MEET OR EXCEED REQUIREMENTS OF ATSM A572, GRADE 50.
3. CAP SLEEVE TO FIT OVER 1 1/2" RCS PILE.
4. STANDARD BASE PLATE WIDTHS ARE 3 1/2", 5", 6 1/2". STANDARD BASE PLATE LENGTH IS 8". STANDARD PLATE THICKNESS IS 1/4".
5. ALL WELDING TO BE PERFORMED BY CERTIFIED WELDOR IN ACCORDANCE WITH AWS D1.1 STRUCTURAL WELDING CODE - STEEL.
6. HOT DIP GALVANIZING PER ASTM A154 / ASTM A123. BARE STEEL IS ALSO AVAILABLE.
7. (1) 3/4" DIAMETER 3" LONG GALVANIZED HEAVY HEX BOLT ASTM A325 AND (1) 3/4" GALVANIZED HEX NUT GRADE A TO BE INCLUDED.
8. HARDWARE FOR BOARDWALK TO BRACKET CONNECTION PROVIDED BY OTHERS.

IDEAL PART # ABBREVIATIONS:

SQ = SQUARE SHAFT PILE
150 = PILE SHAFT THICKNESS
BWB = BOARDWALK BRACKET
[W] = BASE PLATE WIDTH
X = X (SEPARATES PLATE WIDTH AND PLATE LENGTH)
[L] = BASE AND SIDE PLATE LENGTH
B = BOLTED
G = GALVANIZED

DRAWN AP	4/17/2020
CHECKED LRS	4/17/2020
IDEAL MANUFACTURING, INC. 999 PICTURE PARKWAY WEBSTER, NY 14580 800-789-4810 WWW.IDL-GRP.COM	
NOT TO SCALE ALL UNITS IN INCHES U.N.O.	



PROPRIETARY AND CONFIDENTIAL
THE INFORMATION CONTAINED IN THIS
DRAWING IS THE SOLE PROPERTY OF
IDEAL MANUFACTURING, INC. ANY
REPRODUCTION IN PART OR AS A
WHOLE WITHOUT WRITTEN
PERMISSION OF IDEAL
MANUFACTURING, INC. IS PROHIBITED.

SIZE B	DWG NO SQ150BWB	REV 0	SHEET 1 OF 1
-----------	--------------------	----------	--------------